



THE AMERICAN SOCIETY OF BREAST SURGEONS  
*LEAD — Leadership, Education, Advocacy, Dedication*



19<sup>TH</sup> ANNUAL MEETING  
**ORLANDO**  
GRANDE LAKES | May 2–6, 2018



**Program Chair**

**Katharine A. Yao, MD, FACS**

Chief, Division of Surgical Oncology

Vice Chair, Research and Development

Department of Surgery

NorthShore University HealthSystem

Clinical Professor of Surgery

University of Chicago, Pritzker School of Medicine

Evanston, IL

**Pre-Meeting Courses**

**May 2–3**

**General Session**

**May 3–6**

ANNUAL MEETING  
**program**

*The American Society of Breast Surgeons is accredited by the Accreditation Council for Continuing Medical Education to provide continuing medical education for physicians.*

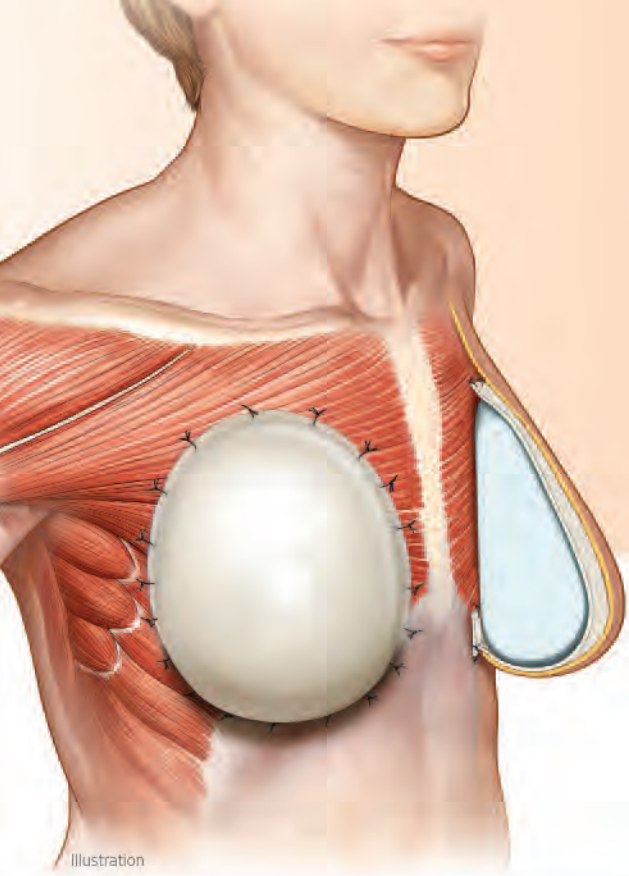

## Prepectoral breast reconstruction has demonstrated the benefits of no muscle elevation

*Less pain.*

*No animation.*

*Better mobility.*

*Faster recovery.*

Physicians should consider whether this procedure is appropriate for patients, including patients with poorly vascularized flaps. As with all implant reconstruction, proceed with caution on patients with prior radiotherapy to the breast, a history of smoking, patients with high body mass index, and very large breasts.

**For more information, visit our booth to talk to an expert.**

May 4 - 5, 2018, 9 AM - 4 PM



**Anne Nickodem, MD, FACS**

Plastic and Reconstructive Surgeon

Private Practice

Annandale, Virginia

**AlloDerm SELECT™ Regenerative Tissue Matrix is an acellular dermal matrix for repair or replacement of damaged or inadequate tissue or for other homologous uses.**

### INDICATIONS AND IMPORTANT SAFETY INFORMATION

#### INDICATIONS

ALLODERM SELECT™ Regenerative Tissue Matrix (ALLODERM SELECT™ RTM) is intended to be used for repair or replacement of damaged or inadequate integumental tissue or for other homologous uses of human integument. This product is intended for single patient one-time use only. ALLODERM SELECT™ RTM is not indicated for use as a dural substitute or intended for use in veterinary applications.

#### IMPORTANT SAFETY INFORMATION

#### CONTRAINDICATIONS

ALLODERM SELECT™ RTM should not be used in patients with a known sensitivity to any of the antibiotics listed on the package and/or Polysorbate 20.

#### WARNINGS

Processing of the tissue, laboratory testing, and careful donor screening minimize the risk of the donor tissue transmitting disease to the recipient patient. As with any processed donor tissue, ALLODERM SELECT™ RTM is not guaranteed to be free of all pathogens. No long-term studies have been conducted to evaluate the carcinogenic or mutagenic potential or reproductive impact of the clinical application of ALLODERM SELECT™ RTM.

**DO NOT** re-sterilize ALLODERM SELECT™ RTM. Discard all open and unused portions of the product. Once a package or container seal has been compromised, the tissue shall be either transplanted, if appropriate, or otherwise discarded. **DO NOT** use if the pouch is opened or damaged. **DO NOT** use product after expiration date noted on the label. Transfer ALLODERM SELECT™ RTM from the foil pouch aseptically. **DO NOT** place the foil pouch in the sterile field.

#### PRECAUTIONS

Poor general medical condition or any pathology that would limit the blood supply and compromise healing should be considered when selecting patients for implanting ALLODERM SELECT™ RTM as such conditions may compromise successful clinical outcome. Whenever clinical circumstances require implantation in a site that is contaminated or infected, appropriate local and/or systemic anti-infective measures should be taken.

ALLODERM SELECT™ RTM has a distinct basement membrane (upper) and dermal surface (lower). When applied as an implant, it is recommended that the dermal side be placed against the most vascular tissue. Soak the tissue for a minimum of 2 minutes using a sterile basin and room temperature sterile saline or room temperature sterile lactated Ringer's solution to cover the tissue. If any hair is visible, remove using aseptic technique before implantation.

ALLODERM SELECT™ RTM should be hydrated and moist when the package is opened. If product is dry, **DO NOT** use. Use of this product is limited to specific health professionals (e.g., physicians, dentists, and/or podiatrists).

#### ADVERSE EVENTS

The most commonly reported adverse events associated with the implant of a tissue graft include, but are not limited to the following: wound or systemic infection; seroma; dehiscence; hypersensitive, allergic or other immune response; and sloughing or failure of the graft.

**ALLODERM SELECT™ RTM is available by prescription only.**

For more information, please see the Instructions for Use (IFU) for ALLODERM SELECT™ RTM available at [www.allergan.com/AlloDermIFU](http://www.allergan.com/AlloDermIFU) or call 1.800.678.1605.

To report an adverse reaction, please call Allergan at 1.800.367.5737.

Reference: 1. Sigalove S, Maxwell GP, Sigalove NM, et al. Prepectoral implant-based breast reconstruction: rationale, indications, and preliminary results. *Plast Reconstr Surg.* 2017;139(2):287-294.



Allergan® and its design are trademarks of Allergan, Inc. ALLODERM SELECT™ and its design are trademarks of LifeCell Corporation, an Allergan affiliate. © 2018 Allergan. All rights reserved. ALS114128 03/18



# Welcome to Grande Lakes!

Dear colleagues,

On behalf of our Society president, Steven Chen, MD, the board of directors, and the annual meeting committee, I welcome you to the 19th Annual Meeting of The American Society of Breast Surgeons at the Grand Lakes Resort in Orlando, Florida. We have an excellent program that advocates for all aspects of a breast surgeon's practice: clinical practice, surgeon satisfaction, technical expertise, research and patient-focused care.



We start the program with our ever-popular pre-meeting courses. New courses offered this year are the Advanced Coding and Documentation course, the Breast Research Tools course and a course on Techniques to Manage Benign and High-Risk Breast Disease. This year's program will also feature a beginner and an intermediate level oncologic skills course and hands-on cadaver lab, the always-popular introductory breast ultrasound and stereotactic breast biopsy courses and a genetics and risk assessment course.

We are pleased to announce a new session titled "The John Wayne Critical Issues in Breast Cancer Forum: The Changing Paradigm for Breast Cancer Surgery," sponsored by the John Wayne Cancer Foundation. This session will discuss the fact that more trials and studies are examining the nonoperative approach to breast cancer surgery and what the implications are to a breast surgeon's practice.

I am also delighted to announce several featured speakers. Kelly Hunt, MD, Chair of the Department of Breast Surgery at MD Anderson Cancer Center, will give the keynote

address on Saturday on "Satisfaction and Sustainability in a Surgical Career," sponsored by the ASBrS Foundation. On Friday, Steven Chen, MD, will give his presidential address, titled "Surgeons as Advocates: A Time for Action."

Please don't forget to attend the Society's annual business meeting Friday afternoon. We will cover the new changes to the maintenance of certification program recently issued by the American Board of Surgery. Saturday afternoon will have an update on the 8th edition AJCC staging manual. Our speakers will familiarize us with the new changes to the staging system for breast cancer and how to implement these changes into our clinical practices.

We will also have several featured sessions, including debates on "benign" topics of atypical ductal hyperplasia and prophylactic mastectomy in older BRCA carriers and on "malignant" topics of sentinel node biopsy for elderly patients, re-excision rates and post mastectomy chest wall radiation therapy. The "Timely Topic" talk will discuss the impact of surgical delays on patient outcomes, and "Science Behind the News" will discuss basic science topics that have been commented on in the media. Lastly, we will have a special session Saturday afternoon that will focus on patient-reported outcomes for breast patients and why it is important to examine patient-reported outcomes.

This year's general session will also feature presentations and discussions on genomics in breast cancer, benign breast disease, updates on locoregional management of breast cancer, systemic treatment updates, breast imaging, environmental risk factors for breast cancer and management of recurrent breast cancer. You will learn tips and tricks from your colleagues through "How I Do It"

videos, hear oral presentations of the latest research and view additional research in our two poster sessions. Sunday morning will feature the popular "Ask the Experts" session where you can get your difficult patient management questions answered. You will also have a chance to hear the latest updates on landmark papers and studies presented in the media and at prominent meetings.

You will also be able to see the latest technology in our Exhibit Hall and network with colleagues during breaks and social functions. We will feature new ePoster kiosks to display the top posters and for our poster discussion with the professors.

I hope you enjoy the Grand Lakes Resort. The staff at Grand Lakes has been wonderful and welcoming to our society and has taken care of every last detail. Both the JW Marriott and Ritz Carlton offer numerous activities and amenities for adults and kids alike, including multiple restaurants, a lazy river, a relaxing spa, and a championship golf course. (Visit the website [www.grandelakes.com](http://www.grandelakes.com) to see for yourself.)

Now is the perfect time to make plans to join us next year for the Society's 20th annual meeting! ASBrS 2019 will be held in Dallas, Texas, at the Hilton Anatole, May 1-5.

I hope you enjoy the meeting and can say that you learned something new for your patients and yourself. We hope to see you in Dallas next year!

Sincerely,

Katharine Yao, MD  
19th Annual Meeting Chair

# 19<sup>TH</sup> ANNUAL MEETING

## cme information

### Meeting Objectives

Upon completion of this live activity, participants should be able to

- Identify current treatment and management options for breast patients
- Assess available studies of breast patients

### Target Audience

Surgeons with a special interest in the treatment of breast disease.

### Accreditation

The American Society of Breast Surgeons is accredited by the Accreditation Council for Continuing Medical Education to provide continuing medical education for physicians.

### Earn up to 22.5 AMA PRA Category 1 Credit(s)<sup>™</sup> Toward Part 2 of ABS Maintenance of Certification (MOC)

This year's general session and pre-meeting courses will not only provide opportunity for surgeons to earn AMA PRA Category 1 Credit(s)<sup>™</sup>, but will also include the self-assessment activities necessary to claim AMA PRA Category 1 Credit(s)<sup>™</sup> toward Part 2 of the American Board of Surgery (ABS) Maintenance of Certification (MOC) Program. These activities are identified in the agenda by this icon: **MOC**

To earn credit, log in as a member/user to the Society website, click on the Annual Meeting tab, and complete the following:

1. Online evaluations for the programs you have attended (CME).
2. Online posttests with a minimum score of 75%, no later than June 18 (MOC).

## AMA Credit Designations PRE-MEETING COURSES

### WEDNESDAY, MAY 2

#### Genetics and Risk Assessment Course

The American Society of Breast Surgeons designates this live activity for a maximum of 7.25 AMA PRA Category 1 Credits<sup>™</sup>. Physicians should claim only the credit commensurate with the extent of their participation in the activity.

**MOC** = 7.25 credits

#### Beginner Oncoplastic Breast Surgery Skills Course with Cadaver Lab

The American Society of Breast Surgeons designates this live activity for a maximum of 8 AMA PRA Category 1 Credits<sup>™</sup>. Physicians should claim only the credit commensurate with the extent of their participation in the activity.

**MOC** = 8 credits

#### Intermediate Oncoplastic Breast Surgery Skills Course with Cadaver Lab

The American Society of Breast Surgeons designates this live activity for a maximum of 8 AMA PRA Category 1 Credits<sup>™</sup>. Physicians should claim only the credit commensurate with the extent of their participation in the activity.

**MOC** = 8 credits

#### Stereotactic Breast Biopsy: An Introductory Course

The American Society of Breast Surgeons designates this live activity for a maximum of 7.75 AMA PRA Category 1 Credits<sup>™</sup>. Physicians should claim only the credit commensurate with the extent of their participation in the activity.

**MOC** = 7.75 credits

### GENERAL SESSION

#### THURSDAY – SUNDAY, MAY 3-6

The American Society of Breast Surgeons designates this live activity for a maximum of 22 AMA PRA Category 1 Credits<sup>™</sup>. Physicians should claim only the credit commensurate with the extent of their participation in the activity.

- Thursday, May 3 = 1 AMA PRA Category 1 Credits<sup>™</sup>
- Friday, May 4 = 8 AMA PRA Category 1 Credits<sup>™</sup> (this includes the sunrise workshops)
- Saturday, May 5 = 9 AMA PRA Category 1 Credits<sup>™</sup>
- Sunday, May 6 = 4 AMA PRA Category 1 Credits<sup>™</sup>

**MOC** = up to 7.25 credits

### THURSDAY, MAY 3

#### Breast Research Tools

The American Society of Breast Surgeons designates this live activity for a maximum of 4.75 AMA PRA Category 1 Credits<sup>™</sup>. Physicians should claim only the credit commensurate with the extent of their participation in the activity.

**MOC** = 4.75 credits

#### Advanced Coding and Documentation

The American Society of Breast Surgeons designates this live activity for a maximum of 3 AMA PRA Category 1 Credits<sup>™</sup>. Physicians should claim only the credit commensurate with the extent of their participation in the activity.

**MOC** = 3 credits

#### Breast Ultrasound: An Introductory Course

The American Society of Breast Surgeons designates this live activity for a maximum of 7.25 AMA PRA Category 1 Credits<sup>™</sup>. Physicians should claim only the credit commensurate with the extent of their participation in the activity.

**MOC** = 7.25 credits

#### Techniques to Manage Benign and High-Risk Breast Disease

The American Society of Breast Surgeons designates this live activity for a maximum of 7 AMA PRA Category 1 Credits<sup>™</sup>. Physicians should claim only the credit commensurate with the extent of their participation in the activity.

**MOC** = 7 credits

### DISCLOSURE INFORMATION

In compliance with ACCME Accreditation Criteria, The American Society of Breast Surgeons, as the accredited provider of this activity, must ensure that anyone in a position to control the content of the educational activity has disclosed all relevant financial relationships with any commercial interest. All reported conflicts have been managed by a designated official to ensure a bias-free presentation. General session disclosures are provided to all attendees separately. Pre-meeting course disclosures are provided in the course programs.

### The American Society of Breast Surgeons

The following individuals and groups have been involved in the planning, implementation, and evaluation of the annual meeting:

#### BOARD OF DIRECTORS

##### President

Steven L. Chen, MD, MBA, FACS

##### President-Elect

Walton A. Taylor, MD, FACS

##### Secretary/Treasurer

Julie A. Margenthaler, MD, FACS

##### Chairman of the Board

Richard E. Fine, MD, FACS

##### Past President

Sheldon Marc Feldman, MD, FACS

##### Directors

Peter W. Blumencranz, MD, FACS

Susan K. Boolbol, MD, FACS

Jill R. Dietz, MD, FACS

Mahmoud El-Tamer, MD, FACS

Nathalie G. Johnson, MD, FACS

Carrie A. Thoms, MD, FACS

##### Executive Director

Jane M. Schuster

#### ANNUAL MEETING COMMITTEE

##### Chair

Katharine A. Yao, MD, FACS

##### Committee

Susan K. Boolbol, MD, FACS

Judy C. Boughey, MD, FACS

Steven L. Chen, MD, MBA, FACS

Sheldon Marc Feldman, MD, FACS

Richard E. Fine, MD, FACS

Rena B. Kass, MD, FACS

Jane E. Méndez, MD, FACS

Walton A. Taylor, MD, FACS

##### Image-Guided Course

##### Ad Hoc Committee

Beth A. Boyd, RN

Richard E. Fine, MD, FACS

#### CME COMMITTEE

##### Chair

Sarah A. McLaughlin, MD, FACS

##### Committee

Joseph Contino, MD, FACS

Courtney Vito, MD, FACS

#### ETHICS COMMITTEE

##### Co-Chairs

Terry Sarantou, MD, FACS

Alyssa Throckmorton, MD, FACS

##### Committee

Emily Bellavance, MD

N. Craig Brackett, III, MD, FACS

Thomas L. Eisenhauer, MD, FACS

Tina J. Hieken, MD, FACS

Nathalie G. Johnson, MD, FACS

David I. Kaufman, MD, FACS

Toan T. Nguyen, MD, FACS

Jennifer K. O'Neill, MD, FACS

Caitlin Patten, MD, FACS

Paige Teller, MD

Sarah Tevis, MD, FACS

Lindi H. VanderWalde, MD, FACS

#### ASBrS STAFF

Marta Boyer

Christina Lucara

Laura Randel

Joseph Schlosnagle

Tekoah White

# 19<sup>TH</sup> ANNUAL MEETING

## Badge Pickup and Onsite Registration Hours

Grande Registration Desk  
JW Marriott, Lobby Level

Tuesday	5:00 pm–7:30 pm*
Wednesday	6:00 am–6:00 pm
Thursday	6:00 am–7:30 pm
Friday	6:00 am–4:30 pm
Saturday	6:00 am–2:00 pm
Sunday	6:30 am–10:00 am

\*pre-meeting course registrants only

## Speaker Ready Room Hours

Cordova 4  
JW Marriott, Lower Level

Tuesday	5:00 pm–7:30 pm
Wednesday	5:00 am–7:30 pm
Thursday	5:00 am–7:30 pm
Friday	5:00 am–6:00 pm
Saturday	5:00 am–6:00 pm
Sunday	6:00 am–10:00 am

## Programs and Services Information Table



Rotunda, JW Marriott, Lobby Level

Friday	9:00 am–4:30 pm
Saturday	9:00 am–4:30 pm

Have questions about our CME programs, membership, Mastery, certification, Nurse BEDI, BESAP, or how to follow the Society on Twitter or Facebook? Stop by the Society's Program and Services Information Table, located in the Rotunda, where staff and volunteers will be available to help you Friday and Saturday.

## Stay Connected!

ASBrS Meeting Space  
Wi-Fi Code ASBS,  
password asbs2018

Share your thoughts, photos and ideas about this year's annual meeting. Follow #ASBrS18 on Twitter or find the Society on Facebook.

**Charging Stations and Cyber Cafe are in the Palazzo Ballroom Prefunction area and outside Mediterranean Ballroom 8 Prefunction area.**

## general information

### Helpful Hints

- Wear comfortable shoes: you'll be walking a lot and may be on your feet for hours at a time.
- Carry plenty of business cards.
- The meeting rooms in the hotel tend to be cool. It's a good idea to bring a sweater or something similar you can throw on if you get cold.
- Use the online program and Meeting App to get a head start on planning your conference schedule and contacting attendees with similar interests and needs.
- Get social! Share your thoughts, photos and ideas about this year's annual meeting. Follow #ASBrS18 on Twitter or find the Society on Facebook.
- Wear your badge to all ASBrS sessions and events, including all social events. Badge pickup is located at the registration desk. **Badges are required for entry to all sessions and events.**
- Find where you're going by accessing our conference maps in the app, program, or signs.
- Printed course materials will not be provided onsite. A complimentary cyber café with printers will be available throughout the conference.
- Put your tickets in a safe place so you will not lose them. A good place is in the back of your badge holder. This is also a good place for business cards.

## Download the ASBrS 19th Annual Meeting Mobile App!

### Navigate the event like a pro with the ASBrS 2018 mobile app

#### With the ASBrS 2018 mobile app, you can:

- Stay organized with up-to-the-minute Exhibitor, Speaker, and Event information
- Sync the app across all your devices with Multi-Device Sync
- Receive important real-time communications from ASBrS
- Build a personalized schedule and bookmark exhibitors
- Locate sessions and exhibitors on the Grande Lakes Orlando venue maps
- Find attendees and connect with your colleagues
- Stay in-the-know and join the conversation using the Social Media icon #ASBrS2018
- And much, much more!



#### Downloading the App is Easy!

**SCAN:** Use your device's QR code scanner to quickly find the ASBrS 2018 app.

**SEARCH:** The App Store or Google Play for "ASBrS Annual Meeting"

**FOR ALL OTHER DEVICE TYPES** (including BlackBerry, Windows, and other web browser-enabled devices):

Point your mobile browser to [www.core-apps.com/dl/asbrs2018](http://www.core-apps.com/dl/asbrs2018) to be directed to the proper download version for your device.

**Platform Compatibility:** Android v4x+ and iOS v7x+

Should you have any questions, please contact [support@core-apps.com](mailto:support@core-apps.com)





# 19<sup>TH</sup> ANNUAL MEETING

## hotel maps



## Audience Engagement Technology through FXP | touch

1. From your smartphone, tablet or laptop, log in to the meeting WiFi network **ASBS** with password **asbs2018**.
2. Open the meeting app and click on the FXP touch link: **join.fxptouch.com**. FXP touch can also be accessed through your web browser by typing in **join.fxptouch.com**, in the address bar.
3. Each event (premeeting course, sunrise workshop, general session) will have its own unique **KEYWORD** which will be provided on the FXP touch slide in your meeting room.
4. Enter the **KEYWORD** provided on the FXP touch slide in your meeting room.
5. Enter your name and email address to log in.
6. At the beginning of the presentation, you will see the presenter's slides on your device. Pinch and zoom to get a better look at each slide.
7. Take notes by tapping the  icon. Notes and slides can be emailed to you after the presentation.
8. If your session offers eQ&A, simply tap the  icon to submit your question.
9. Sessions with ARS will use this technology, so get ready to vote on your device. This could be in the form of a multiple choice question, a thumbs up/down response, or a sliding rating on a scale. These icons will automatically appear on your device. Tap on the icon to send in your vote.
10. If at any time your device is not keeping up with the main screen, simply click this icon  to get back in sync.
11. Let presenters know how they did by rating them and their content on the two sliding scales that will display at the end of their presentations.

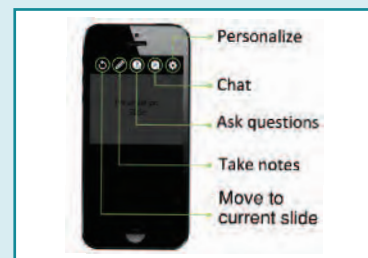

# 19<sup>TH</sup> ANNUAL MEETING

## pre-meeting courses

### WEDNESDAY, MAY 2

6:30am–4:00pm

#### **Beginner Oncoplastic Breast Surgery Skills Course with Cadaver Lab** MOC

*Moderator:* Dennis Holmes, MD

Transportation to the Nicholson Center (off-site) will be provided and will depart at 6:30am. Registered attendees must meet at the **JW Marriott Grande Registration Desk, Lobby Level** for check-in at 6:15am. For details, please refer to the lab instructions email or visit the registration desk.

6:30am–4:00pm

#### **Intermediate Oncoplastic Breast Surgery Skills Course with Cadaver Lab** MOC

*Moderator:* Juliann Reiland, MD

Transportation to the Nicholson Center (off-site) will be provided and will depart at 6:30am. Registered attendees must meet at the **JW Marriott Grande Registration Desk, Lobby Level** for check-in at 6:15am. For details, please refer to the lab instructions email or visit the registration desk.

7:00am–7:30am

Registration and Breakfast

7:30am–4:30pm

#### **Genetics and Risk Assessment Course** MOC

*Palazzo Ballroom A, JW Marriott, Lobby Level*

*Moderator:* Molly Sebastian, MD

7:30am–4:30pm

#### **Stereotactic Breast Biopsy: An Introductory Course** MOC

*Lecture: Siena, Ritz Carlton, Lower Level*

*Workshop: Segura, JW Marriott, Lower Level*

*Moderators:* Sharla Gayle Patterson, MD and Victor Zannis, MD

7:30pm–9:30pm

**NEW IN 2018!**

#### **INDUSTRY SYMPOSIUM, Ambry Genetics, Inc.**

#### **Screening or Scalpel: How Genetic Testing for Hereditary Breast Cancer Can Guide Patient Care**

*Ritz Carlton Ballroom Salon IV, Lobby Level*

*NOTE: This satellite symposium is supported by Ambry Genetics, Inc. through a marketing grant. It is not part of the official program of the ASBrS. CME credits for these programs, if applicable, will not be provided by the ASBrS. This activity is open to all registered attendees.*

### THURSDAY, MAY 3

#### Half-Day Courses

7:00am–12:30pm

#### **Breast Research Tools** MOC

*Palazzo Ballroom C, JW Marriott, Lobby Level*

*Moderator:* Lee Wilke, MD

12:30pm–4:00pm

#### **Advanced Coding and Documentation** MOC

*Palazzo Ballroom A, JW Marriott, Lobby Level*

*Moderators:* Janie Grumley, MD and Terry Sarantou, MD

#### Full-Day Concurrent Courses

6:30am–7:00am

Registration and Breakfast

6:30am–3:30pm

#### **Breast Ultrasound: An Introductory Course** MOC

*Lecture: Ritz Carlton Ballroom Salons V-VI, Lobby Level*

*Workshop: Ritz Carlton Ballroom Salons I-III, Lobby Level*

*Moderators:* Michelle Carpenter, MD and Shawna Willey, MD

6:30am–3:30pm

#### **Techniques to Manage Benign and High-Risk Breast Disease** MOC

*Palazzo Ballroom D, JW Marriott, Lobby Level*

*Moderators:* Sarah McLaughlin, MD and Jane Méndez, MD

11:45am–12:45pm

Breast Fellows Lunch

*Palazzo Ballroom F, JW Marriott, Lobby Level*

1:00pm–4:00pm

#### **Fellows Track** (\*pre-registration required)

*Palazzo Ballroom G, JW Marriott, Lobby Level*

*Moderators:* Susan Boolbol, MD and Brigid Killelea, MD

\*The Fellows Track is a special supplemental session designed to address the unique needs of current and prospective breast fellows. Participation in the program is reserved for fellows participating in a year-long multidisciplinary breast surgery fellowship program and residents entering or interested in a breast fellowship. Pre-registration was required.

## Conference Video and Photography Policy

**GENERAL SESSION:** Non-flash photography and audio or video recording using hand-held equipment for strictly personal, social, or noncommercial use are permitted in the general session if not disruptive as determined by ASBrS. However, recording or live-streaming sessions or presentations in their entirety is strictly prohibited without prior permission from the ASBrS. ASBrS and the authors/presenters (as appropriate) retain copyright to their own work and reserve the right to ask for takedown of copyrighted material, this policy notwithstanding.

**PRE-MEETING COURSES:** Photography & video recordings are strictly prohibited.

## The American Society of Breast Surgeons Lifetime Achievement Award Presented to Balazs “Ernie” Bodai, MD, FACS

Ernie Bodai, MD, was born in Budapest, Hungary in 1951. He and his family lived in a bomb shelter for nearly a year before they managed to escape during the Hungarian Revolution in 1957. Following immigration to the US, Dr. Bodai received a BA and MS from the University of California, Los Angeles. He received his MD degree from the UC-Davis, in 1977, where he currently serves as Clinical Professor of Surgery.



He has authored over 250 medical articles and has published 5 books. He holds a number of medical device patents, is a member of numerous surgical societies and is the recipient of many national awards. He serves on The American College of Surgeons Commission on Cancer.

After treating thousands of patients with breast cancer, he became frustrated at the pace of funding for research. In a remarkable one-man lobbying effort, he was able to convince Congress and the U.S. Postal Service to issue the Breast Cancer Research Stamp – the first ever stamp in U.S. history that sells at more than face value with the surplus amount donated to breast cancer research. Over 986 million stamps have been sold, raising nearly \$95 million for research.



## Visit the American Society of Breast Surgeons Foundation Table, Get a Chance to win a \$500 American Express Gift Card

### How to Participate:

1. Look for the Explore for More card in your Final Program.
2. Visit the exhibitors listed on the card.
3. Drop off your card at the American Society of Breast Surgeons Foundation Table.

### Other Great Reasons to Visit the American Society of Breast Surgeons Foundation Table:

1. Get a *fancy lanyard* for your attendee badge.
2. Turn in your Explore for More card for chances to *win gift cards and prizes!*
3. *Vote for your favorite posters by category for more chances to win gift cards and prizes.*
4. Pick up *free Breast360 cards* that you can hand out to patients, complementing your clinical guidance and care.
5. *Make a charitable donation* that supports the Foundation's public outreach, promoting patients, and helping under served populations.

Thank you in advance for participating and supporting the American Society of Breast Surgeons Foundation, a 501 (c)3 charitable organization, dedicated to advancing breast care to all populations, and enhancing the patient's experience.

**Foundation Table**  
Mediterranean Ballroom Salon 4  
Pre-function JW Marriott, Lobby Level

Thursday.....2:00 pm–6:00 pm  
Friday .....9:00 am–4:30 pm  
Saturday .....9:00 am–4:30 pm

**breast360.org**  
engage • educate • empower

breast360.org is a patient resource provided by  
The American Society of Breast Surgeons Foundation  
[www.breastsurgeonsfoundation.org](http://www.breastsurgeonsfoundation.org)



# 19<sup>TH</sup> ANNUAL MEETING

## thursday general session

MAY 3

*Mediterranean Ballroom, JW Marriott, Lobby Level*

4:00 pm–4:15 pm

### Welcome

Steven Chen, MD, MBA,  
Katherine Yao, MD

4:15 pm–5:15 pm

### Coding and Reimbursement Symposium

*Moderators:* Richard Fine, MD,  
Costanza Cocilovo, MD,  
Amanda Wheeler, MD

5:30 pm–7:30 pm

### INDUSTRY SYMPOSIUM

#### Why Big Clinical Trials Still Matter And What To Expect From TAILORx What Can We Look Forward To?

Genomic Health, Inc.

*Panel:*

Larry Norton, MD, Medical Oncologist, Deputy Physician-in-Chief for Breast Cancer Programs; Medical Director, Evelyn H. Lauder Breast Center; Norna S. Sarofim Chair in Clinical Oncology, Memorial Sloan Kettering Cancer Institute

Terry Mamounas, MD MPH, FACS, Medical Director, Orlando Health UF Health Cancer Center

Steve Shak, MD, Co-Founder & Chief Scientific Officer, Genomic Health

*NOTE: This satellite symposium is supported by Genomic Health, Inc., through a marketing grant. It is not part of the official program of the ASBrS. CME credits for these programs, if applicable, will not be provided by the ASBrS. This activity is free to all registered attendees.*

7:30 pm–9:00 pm

### Opening Reception in Exhibit Hall

*Coquina Ballroom, JW Marriott, Lobby Level*



### Next-Day Access to General Session Presentations and Evaluations Available to Meeting Attendees

Attendees can access PowerPoint presentations in real-time on any device using our new Audience Engagement Technology, FXP Touch. See page 4 for instructions.

2018 meeting attendees will be able to view and/or download general session PowerPoint presentations (with some exceptions) via the Society website approximately 24 hours following each live presentation. To access, you must log onto [www.breastsurgeons.org](http://www.breastsurgeons.org) as a member or registered user and be a 2018 annual meeting registrant.

### Free Online Access to Video Recordings of General Session for All Registered Attendees

Video recordings of each general session presentation, integrated with the PowerPoint presentations (with some exceptions), will be available online FREE to all meeting registrants approximately 4 to 6 weeks following the meeting. Providing materials online following the program ensures that attendees have access to the actual presentations used by each speaker onsite.

6:45 am–7:45 am

### Sunrise Workshops

Continental breakfast provided. Pre-purchased tickets required.

- |  |  |
|--|--|
| <p><b>B1 Mastering Mastery of Breast Surgery</b><br/><i>Palazzo Ballroom Salon F, JW Marriott, Lobby Level</i><br/>Linda Smith, MD; Kathryn Wagner, MD</p> <p><b>B2 Managing Margins for Invasive and Noninvasive Cancer</b> <b>MOC</b><br/><i>Ritz Carlton Ballroom Salon I, Lobby Level</i><br/>Swati Kulkarni, MD; Heather Neuman, MD</p> <p><b>B3 Interacting with the Media and Advocacy Groups</b><br/><i>Palazzo Ballroom Salon G, JW Marriott, Lobby Level</i><br/>Jay Harness, MD; Deanna Attai, MD</p> <p><b>B4 Oncoplastics for Dummies</b> <b>MOC</b><br/><i>Ritz Carlton Ballroom Salon VI, Lobby Level</i><br/>Patricia Clark, MD; Katherine Kopkash, MD</p> <p><b>B5 How to Order Genetic Testing for Your High-Risk Patients</b><br/><i>Palazzo Ballroom Salon B, JW Marriott, Lobby Level</i><br/>Kevin Hughes, MD; Pat Whitworth, MD</p> | <p><b>B6 Sentinel Node Biopsy and Neoadjuvant Therapy</b><br/><i>Ritz Carlton Ballroom Salon II, Lobby Level</i><br/>Elizabeth Shaughnessy, MD, PhD; Richard White, Jr., MD</p> <p><b>B7 Nipple-Sparing Mastectomy: Incision Location, Technical Considerations</b><br/><i>Ritz Carlton Ballroom Salon V, Lobby Level</i><br/>Suzanne Coopey, MD; Stephen Grobmyer, MD</p> <p><b>B8 Oncofertility</b> <b>MOC</b><br/><i>Palazzo Ballroom C, JW Marriott, Lobby Level</i><br/>Jacqueline Jeruss, MD, PhD; Bruce Rose, MD, PhD</p> <p><b>B9 Survivorship: How to Set Up a Survivorship Program that Fulfills ASCO, CoC and NAPBC Criteria</b><br/><i>Palazzo Ballroom A, JW Marriott, Lobby Level</i><br/>Ted James, MD; Terry Sarantou, MD</p> <p><b>B10 Pregnancy and Breast Cancer</b><br/><i>Palazzo Ballroom H, JW Marriott, Lobby Level</i><br/>Katherina Zabicki Calvillo, MD; Saranya Chumsri, MD; Catherine Lee, MD</p> |
|--|--|

## Poster Sessions and Receptions

Friday, 6:00 pm–7:30 pm; Saturday, 7:30 pm–8:30 pm

*Palazzo Ballroom D, JW Marriott, Lobby Level*

Don't miss this opportunity to review the latest scientific developments. Enjoy light refreshments in a relaxing atmosphere as you meet the presenters during each of this year's two poster sessions. Posters have been divided into distinct categories each session to enhance viewing. Poster Session I will be Friday evening, and Poster Session II will be Saturday night, immediately following the President's Reception. Join Dr. Emilia Diego and Dr. Funda Meric-Bernstam for guided poster rounds featuring the top 12 posters during Friday's reception. The top 12 posters will be available on Friday and Saturday in the poster hall on our new ePoster displays. Free to all registered attendees.

Friday, 6:00 pm–7:30 pm

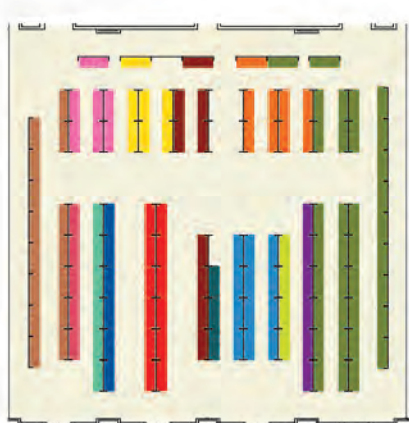

#### SUBJECT LEGEND

- Benign Breast Disease
- DCIS
- Complications
- CPM
- NSM
- Reconstruction
- Top Posters
- Oncoplastics
- Phyllodes
- SLN
- SLN/NAC
- NAC
- Tumor Genetics
- Other

Saturday, 7:30 pm–8:30 pm

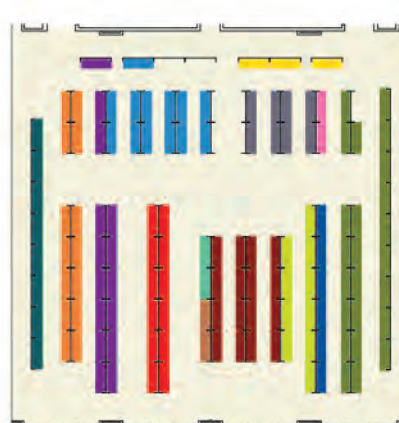

#### SUBJECT LEGEND

- Age Extremes
- Disparities
- Genetics
- Imaging
- Top Posters
- Local Regional Recurrence
- Lymphedema
- Margins
- Radiation
- Localization
- Stage IV
- Time to Treatment
- Male Breast Cancer
- Other

**PALAZZO BALLROOM**  
LOBBY LEVEL

### *Mediterranean Ballroom, JW Marriott, Lobby Level*

7:15am-8:00am **Breakfast**

*Continental breakfast will be served on the **Mediterranean Porte Cochere, JW Marriott, Lobby Level** for participants not attending a Sunrise Workshop*

8:00 am–8:15 am **Welcome**

Katharine Yao, MD

8:15 am–9:30 am **The John Wayne Critical Issues in Breast Cancer Forum: The Changing Paradigm for Breast Cancer Surgery**

*Moderator:* David Ollila, MD

*Supported by an educational grant from the John Wayne Cancer Foundation*

- ▶ Observation of DCIS
- ▶ Omitting Sentinel Node Biopsy
- ▶ No Surgery in pCR Patients After Neoadjuvant Therapy
- ▶ Ablation of Tumors
- ▶ Future of Breast Surgery – Perspectives
- ▶ Q&A

E. Shelley Hwang, MD  
David Ollila, MD  
Henry Kuerer, MD, PhD  
David Brenin, MD  
Sheldon Feldman, MD

9:30am–10:00am **Break in Exhibit Hall, *Coquina Ballroom, JW Marriott, Lobby Level***

10:00am–11:00am **Breast Cancer Genomics** MOC

*Moderator:* Kevin Hughes, MD

- ▶ BRCA Mutation Updates
- ▶ Risk Prediction – Polygenic Risk Scores
- ▶ Beyond BRCA
- ▶ Universal Testing
- ▶ Q&A

David Euhus, MD  
Kevin Hughes, MD  
Mark Robson, MD  
Funmi Olopade, MD

11:00am–11:15am **Timely Topic: Timing of Breast Cancer Treatments**

Richard Bleicher, MD

### Scientific Session Abstracts

All scientific abstracts presented, either orally or as a poster, at this year's meeting can be viewed as follows:

- Through the ASBrS Annual Meetings mobile app (See page 3.)
- On the 2018 Annual Meeting page of the Society website (Click on "2018 Official Proceedings.")



### INDUSTRY SYMPOSIA

Industry-supported symposia, which have been made possible through marketing support, will be held Wednesday, Thursday and Friday evening, and Saturday morning. Details on these industry-supported symposia can be seen on pages 5, 7, and 9 in this program.

*Industry symposia are not part of the official program of the ASBrS. CME credits for these programs, if applicable, will not be provided by the ASBrS. These activities are free to all registered attendees.*

## friday general session

MAY 4

*Mediterranean Ballroom, JW Marriott, Lobby Level*

11:15am–Noon **PRESIDENTIAL ADDRESS** Steven Chen, MD, MBA

**“Surgeons as Advocates: A Time for Action”**

Introduction by President-Elect Walton Taylor, MD

Noon–1:15pm Lunch in Exhibit Hall, *Coquina Ballroom, JW Marriott, Lobby Level*

**Special Interest Lunches**

- ▶ American College of Surgeons CRP Investigator’s Meeting *(by invitation only)*, *Marbella 4, JW Marriott, Lower Level*
- ▶ ASBrS Mentor/Mentee Luncheon *(by invitation only)*, *Palazzo Ballroom A, JW Marriott, Lobby Level*
- ▶ NSMR Investigators Meeting *(by invitation only)*, *Palazzo Ballroom C, JW Marriott, Lobby Level*
- ▶ Oncoplastics Town Hall, *Palazzo Ballroom F, JW Marriott, Lobby Level*

1:15pm–2:15pm **Benign Breast Primer** **MOC** *Moderator:* Gary Unzeitig, MD

- ▶ Granulomatous Mastitis *Stephen Sener, MD*
- ▶ The Bacteria Behind Breast Infections *Catherine Pesce, MD*
- ▶ Dermatology Problems of the Breast *Alyssa Throckmorton, MD*
- ▶ Chronic Seroma *Faina Nakhlis, MD*
- ▶ Itchy/Painful Breast *Marissa Howard-McNatt, MD*
- ▶ Case Presentations *Stephen Sener, MD*

2:15pm–3:30pm **Scientific Oral Presentations I** *Moderators:* Judy Boughey, MD  
Mahmoud El-Tamer, MD

- *Lymph Node Status Does Not Predict Tumor Biology* *Danielle Bello, MD*
- *Local Recurrence Rates After Breast Conserving Therapy in Patients Receiving Modern Era Therapy* *Heather Neuman, MD*
- *Chronic Pain After Breast Surgery: A Prospective Observational Trial* *Tara Spivey, MD*
- *HBOC patients who do not meet Medicare criteria for genetic testing have similar rates of clinically actionable findings as those who do meet criteria.* *Jennifer Axilbund, MS, CGC*
- *Are Genetic Testing Guidelines Still Relevant?* *Peter Beitsch, MD*

3:30pm–4:00pm Break in Exhibit Hall, *Coquina Ballroom, JW Marriott, Lobby Level*

4:00pm–4:45pm **Updates in Loco-regional Treatment of Breast Cancer** **MOC** *Moderator:* Hiram Cody, III, MD

- ▶ Loco-regional Recurrence *Monica Morrow, MD*
- ▶ Bilateral Mastectomy – in the Age of Genetics *Todd Tuttle, MD*
- ▶ Breast Radiation After Lumpectomy *Meena Moran, MD*
- ▶ Axillary Surgery *Judy Boughey, MD*
- ▶ Q&A

4:45pm–5:15pm **Annual Business Meeting**

- President’s Opening Remarks *Steven Chen, MD, MBA*
- Finance Report *Julie Margenthaler, MD*
- Society Updates:
  - DC Updates *Steven Chen, MD, MBA*
  - ABS Continuous Certification Program *Peter Beitsch, MD*

*Mediterranean Ballroom, JW Marriott, Lobby Level*

- **Election of new officers**

Slate of Candidates:

- President: Walton Taylor, MD
- President-Elect: Jill Dietz, MD
- Chair of Board: Shawna Willey, MD
- Member-at-Large: Paul Baron, MD, Judy Boughey, MD, and Eric Manahan, MD

Steven Chen, MD, MBA

5:15pm–6:00pm

### Benign Debates

- ▶ Prophylactic Mastectomy in a 65 Year Old BRCA Carrier: **YES**  
Prophylactic Mastectomy in a 65 Year Old BRCA Carrier: **NO**
- ▶ Excise ADH: **YES**  
Excise ADH: **NO**

*Moderator:* Scott Kurtzman, MD  
Barbara Smith, MD  
Shawna Willey, MD  
Isabelle Bedrosian, MD  
Amy Degnim, MD

6:00pm–7:30pm

### Poster Session and Reception I, *Palazzo Ballroom D, JW Marriott, Lobby Level*

Top 12 Poster Discussion

*Moderators:* Emilia Diego, MD  
Funda Meric-Bernstam, MD

7:30pm–9:30pm

### EVENING INDUSTRY SYMPOSIA

- ▶ Genentech, Inc., **Presurgical Considerations for Patients with Early Breast Cancer**, *Palazzo Ballroom F, JW Marriott, Lobby Level*
- ▶ Inuity, Inc., **Innovative Technology For Oncoplastic Breast Conserving Surgery and Nipple Sparing Mastectomy**, *Palazzo Ballroom A, JW Marriott, Lobby Level*

*These satellite symposia are supported by industry through marketing grants. They are not part of the official program of the ASBrS. CME credits for these programs, if applicable, will not be provided by the ASBrS. These activities are free to all registered attendees.*



THE AMERICAN SOCIETY OF  
**Breast Surgeons**

#### PAST PRESIDENTS

1995 – 1997.....Robert B. Caplan, MD  
1997 – 1999.....C. Alan Henry, MD  
1999 – 2000.....Rache M. Simmons, MD  
2000 – 2001.....Mark A. Gittleman, MD  
2001 – 2002.....Arthur G. Lerner, MD  
2002 – 2003.....Michael J. Edwards, MD  
2003 – 2004.....Richard E. Fine, MD  
2004 – 2005.....Lorraine Tafra, MD  
2005 – 2006.....Edgar D. Staren, MD, PhD, MBA  
2006 – 2007.....Helen A. Pass, MD  
2007 – 2008.....Jay K. Harness, MD  
2008 – 2009.....Shawna C. Willey, MD  
2009 – 2010.....Victor J. Zannis, MD  
2010 – 2011.....Eric B. Whitacre, MD  
2011 – 2012.....Howard C. Snider, Jr., MD  
2012 – 2013.....V. Suzanne Klimberg, MD, PhD  
2013 – 2014.....Peter D. Beitsch, MD  
2014 – 2015.....Hiram S. Cody, III, MD  
2015 – 2016.....Deanna J. Attai, MD  
2016 – 2017.....Sheldon Marc Feldman, MD

6:15 am-7:45 am

### Breakfast Industry Symposia

- ▶ 23andMe, Inc., **Underutilized to Ubiquitous: Genetic Testing for Breast Cancer**, *Ritz Carlton Ballroom I-II, Lobby Level*
- ▶ Albert Einstein College of Medicine, **An Overview of an Anesthesiologist and Surgeon's Effective Approach to Opioid Minimalization**, *Ritz Carlton Ballroom Salon III, Lobby Level*
- ▶ Cianna Medical, **Moving Beyond Wires: Oncoplastic Techniques with SCOUT®**  
*Palazzo Ballroom F, JW Marriott, Lobby Level*
- ▶ Focal Therapeutics, Inc., **Improving Outcomes with Oncoplastic Surgery: Techniques in "Reconstructive Lumpectomy"**,  
*Ritz Carlton Ballroom Salon IV, Lobby Level*
- ▶ ImpediMed, Inc., **SOZO® - L-Dex®, Bilateral, Heart Failure, and we're just getting started...**, *Palazzo Ballroom A, JW Marriott, Lobby Level*

*NOTE: These satellite symposia are supported by industry through marketing grants. They are not part of the official program of the ASBrS. CME credits for these programs, if applicable, will not be provided by the ASBrS. These activities are free to all registered attendees.*

*Mediterranean Ballroom, JW Marriott, Lobby Level*

7:15am-8:00am

### Breakfast

*Continental breakfast will be served on the Mediterranean Porte Cochere for participants not attending an Industry Symposia*

8:00am-8:45am

### Considerations for Systemic Treatment MOC

- ▶ Genomic Assays for Adjuvant Therapy Decisions
- ▶ Who Should I Send for Neoadjuvant Therapy?
- ▶ Adjuvant Hormonal Therapy – When and For How Long?
- ▶ Timing of Reconstruction for Patients Undergoing Systemic Therapy
- ▶ Q&A

*Moderator:* Terry Mamounas, MD  
Ruth O'Regan, MD  
Elizabeth Comen, MD  
Gini Fleming, MD  
Mark Sisco, MD

8:45am-9:00am

### Science Behind the News

- ▶ Immunotherapy
- ▶ Liquid Biopsy

*Moderator:* Funda Meric-Bernstam, MD  
Brian Czerniecki, MD, PhD  
Anthony Lucci, MD

9:00am-9:15am

### The American Society of Breast Surgeons Lifetime Achievement Award

*Presented to Balazs "Ernie" Bodai, MD, FACS*

*Presenter:* Steven Chen, MD, MBA

9:15am-9:45am

### Break in Exhibit Hall, *Coquina Ballroom, JW Marriott, Lobby Level*

9:45am-10:30am

### Best Papers and Posters Review

- ▶ Papers/Studies Presented in the Media
- ▶ SABCS Poster Review
- ▶ Best Papers of the Year

*Moderator:* V. Suzanne Klimberg, MD, PhD  
Julie Margenthaler, MD  
Nora Jaskowiak, MD  
Helen Pass, MD

10:30am-11:15am

### Breast Imaging Update MOC

- ▶ Breast Density and Breast Cancer Risk
- ▶ Emerging Modalities-Automated Breast Ultrasound, Breast Density Legislation and Molecular Breast Imaging
- ▶ 3D Tomosynthesis and Contrast Enhanced Mammography
- ▶ Summary Statement for High-Risk Imaging Surveillance

*Moderator:* Paul Baron, MD  
Gillian Newstead, MD  
  
Georgia Spear, MD  
Sarah Friedewald, MD  
Paul Baron, MD



**Kelly K. Hunt, MD, FACS**  
*Hamill Foundation Distinguished Professor of Surgery in Honor of Dr. Richard G. Martin, Sr. Chair, Department of Breast Surgical Oncology, The University of Texas MD Anderson Cancer Center*

### Keynote Speaker

The ASBrS Foundation is pleased to present Kelly Hunt, MD, as the 2018 Keynote Speaker. A gifted surgeon and compassionate clinician, Dr. Hunt's work focuses on finding less invasive yet more effective surgical procedures for patients with breast cancer and soft-tissue sarcomas. As an international leader in breast cancer research, she has directed major clinical trials whose results have changed practice in breast cancer. Dr. Hunt's work has led to the revision of the AJCC staging system for breast cancer to incorporate biological factors for more accurate determination of prognosis for breast cancer patients. Dr. Hunt also has an active laboratory that studies cell-cycle deregulation in breast and other cancers.



*Dr. Steven Chen receives the presidential gavel from his predecessor, Dr. Sheldon Feldman in 2017.*

### President's Reception and Award Presentations

Saturday, May 5  
 6:30 pm — 7:30 pm

*Valencia Terrace, JW Marriott, Lower Level*

Join your colleagues immediately following the general session to toast the Society's outgoing president, Dr. Steven Chen, and congratulate the scientific session award winners.

11:15am–Noon

### KEYNOTE ADDRESS

#### “Satisfaction and Sustainability in a Surgical Career”

Supported by The American Society of Breast Surgeons Foundation

Introduction by Steven Chen, MD

Kelly Hunt, MD



Noon–1:30pm

Lunch in Exhibit Hall, *Coquina Ballroom, JW Marriott, Lobby Level*

Noon–1:30pm

### Quickshot Presentations Lunch

*Ritz Carlton Ballroom III, Lobby Level*

- *Oncotype DX® Recurrence Score as a Predictor of Response to Neoadjuvant Chemotherapy*
- *Association of 21-gene Recurrence Score results with surgical intervention received after neoadjuvant hormonal therapy: Secondary endpoints of the TransNEOS validation study*
- *Utility of Expedited Hereditary Cancer Testing In Surgical Management of Newly Diagnosed Breast Cancer Patients*
- *Patient Preferences for DCIS Treatment Strategies: A Discrete-Choice Experiment*
- *Predicting non-sentinel lymph node metastases in patients with a positive sentinel lymph node after neoadjuvant chemotherapy*
- *Prospective Evaluation Of Quality Of Life For Patients With Breast Cancer Treated With Breast Conserving Surgery, Mastectomy Alone And Mastectomy With Immediate Breast Reconstruction*
- *No change in contralateral prophylactic mastectomy rates after implementation of a patient educational handout based on the 2016 ASBrS consensus statement: an ongoing quality improvement initiative*
- *Multidisciplinary Margin Assessment Reduces Number of Positive Margins*
- *Litigation for Breast Cancer Care: Delay in Diagnosis Continues to Top the Chart*
- *Reducing Breast Cancer Related Lymphedema (BCRL) Through Prospective Surveillance Monitoring Using Bioimpedance Spectroscopy (BIS) and Patient Directed Self-Interventions*

*Moderators:* Jill Dietz, MD  
 Henry Kuerer, MD, PhD

Ryan Gruner, MD

Hiroji Iwata, MD, PhD

Darrow Speyer, MGC, CGC

Brittany Campbell, BS

Alison Barron, MD

Helene Retrouvey, MD

Lacey Stelle, MD

Sarah Tevis, MD

Brittany Murphy, MD

Lyndsey Kilgore, MD

## saturday general session

MAY 5

*Mediterranean Ballroom, JW Marriott, Lobby Level*

1:30pm–2:00pm

### “How I Do It” Videos

- ▶ Magseed localized Round block resection and sentinel node biopsy
- ▶ Oncoplastic surgery with immediate CU flap nipple reconstruction for centrally located multifocal breast cancer
- ▶ Triple Mapping to Optimize Axillary Management in Breast Cancer Patients after Neoadjuvant Therapy
- ▶ Prepectoral Implant Reconstruction After Nipple-Sparing Mastectomy

*Moderator:* Mehra Golshan, MD  
Jill Dietz, MD

Abhishek Chatterjee, MD

Sabrina Shilad, MD

Preya Ananthakrishnan, MD

2:00pm–3:15pm

### Scientific Oral Presentations II

- *Axillary Nodal Evaluation in Elderly Breast Cancer Patients: Potential Effects on Treatment Decisions and Survival*
- *The feasibility of breast-conserving surgery for multiple ipsilateral breast cancer: An initial report from ACOSOG Z11102 Alliance trial*
- *The Impact of Post-Mastectomy Chest Wall Radiation on Prepectoral Implant-Based Breast Reconstruction*
- *Long-Term Patient Satisfaction After Nipple-Sparing Mastectomy and Conventional Mastectomy with Reconstruction Does Not Differ Significantly*
- *Is Age Trumping Genetic Profiling in Clinical Practice? Relationship of Chemotherapy Recommendation and Oncotype DX Recurrence Score in Patients <50 versus >50 and Trends Over Time.*

*Moderators:* Judy Boughey, MD  
Roshni Rao, MD

Nina Tamirisa, MD

Kari Rosenkranz, MD

Anke Young, MD

Anya Romanoff, MD

Austin Williams, MD, MEd

3:15pm–3:45pm

Break in Exhibit Hall, *Coquina Ballroom, JW Marriott, Lobby Level*

3:45pm–4:40pm

### Patient Reported Outcomes for Breast Patients

- ▶ Intro and Explanation of What a PRO Is
- ▶ Breast Specific PROs Currently Available
- ▶ Why PROs are Important to Study From a Provider and Payment Perspective
- ▶ Q&A

*Moderators:* Jill Dietz, MD  
Ted James, MD  
Ted James, MD  
Andrea Pusic, MD

James Merlino, MD

*Faculty,* Henry Kuerer, MD, PhD  
Katharine Yao, MD

4:40pm–5:00pm

### AJCC 8th Edition Update

Stephen Edge, MD  
David Winchester, MD

5:00pm–6:15pm

### Malignant Debates

- ▶ Sentinel Node Biopsy for Women  $\geq$  70 Years Old: YES  
Sentinel Node Biopsy for Women  $\geq$  70 Years Old: NO
- ▶ Should Re-excision Rates Be a Quality Measure?: YES  
Should Re-excision Rates Be a Quality Measure?: NO
- ▶ PMRT For One Tumor Positive Node: YES  
PMRT For One Tumor Positive Node: NO

*Moderator:* Susan Boolbol, MD  
Sarah Blair, MD  
Lorraine Tafra, MD  
Anees Chagpar, MD  
Lee Wilke, MD  
Nancy DeMore, MD  
Elizabeth Mittendorf, MD, PhD

6:30pm–7:30pm

### President’s Reception and Awards Presentation

*Valencia Lawn, JW Marriott, Lower Level*

7:30pm–8:30pm

### Poster Session and Reception II

*Palazzo Ballroom D, JW Marriott, Lobby Level*



## sunday general session

MAY 6

6:30am-8:30am

### Breakfast

Continental breakfast will be served on the Mediterranean Porte Cochere

*Mediterranean Ballroom, JW Marriott, Lobby Level*

7:00am-8:15am

### Ask the Breast Experts

Submit challenging cases for discussion through FXP touch to get the experts' opinion.

- ▶ Medical Oncology
- ▶ Radiation Oncology
- ▶ Surgery
- ▶ Genetics
- ▶ Plastic Surgery
- ▶ Radiology
- ▶ Patient Advocate

**Moderator:** Jane Méndez, MD

Massimo Cristofanilli, MD  
 Marcio Fagundes, MD  
 Hiram Cody, III, MD, Lisa Newman, MD  
 Molly Sebastian, MD  
 Mark Sisco, MD  
 Georgia Spear, MD  
 Stacey Tinianov

8:15am-9:00am

### Continually Changing Health Care Landscape in 2018

- ▶ Legislative Updates on the National Scene: MIPS, APMs, ACA
- ▶ Evolving Reimbursement Models
- ▶ Quality Measures
- ▶ Q&A

**Moderator:** Abhishek Chatterjee, MD

Cindy Moon, MPP, MPH  
 Terry Sarantou, MD  
 Roshni Rao, MD

9:00am-10:00am

### Management of Recurrent Breast Cancer MOC

- ▶ Breast Cancer Recurrences: Natural History
- ▶ Management of In-breast Tumor Recurrences
- ▶ Brief Primer on Distant Recurrence: When to Operate?
- ▶ Case Presentations

**Moderator:** Irene Wapnir, MD

Terry Mamounas, MD  
 Mehra Golshan, MD  
 Massimo Cristofanilli, MD  
 Irene Wapnir, MD

10:00am-11:00am

### Environmental Risk Factors MOC

- ▶ Diet, Obesity and Breast Cancer Risk
- ▶ Hormone Replacement Therapy
- ▶ Previous Radiation Exposure
- ▶ Risk Factors in Other Countries
- ▶ Q&A

**Moderator:** Jan Wong, MD

Rowan Chlebowski, MD, PhD  
 Marie Wood, MD  
 Hiram Cody, III, MD  
 Lisa Newman, MD

11:00am

### Adjourn



*See you next year in Dallas for our 20th!*

# 19<sup>TH</sup> ANNUAL MEETING

## faculty and presenters

**Deanna J. Attai, MD, FACS**  
David Geffen School of Medicine  
at UCLA  
Burbank, CA  
@DrAttai

**Jennifer Axilbund, MS, CGC**  
Invitae Corporation  
San Francisco, CA

**Karen S. Barbosa, DO, FACOS**  
Alaska Breast Care Specialists  
Anchorage, AK

**Paul L. Baron, MD, FACS**  
Roper St. Francis Physician Partners  
Breast Surgery  
Charleston, SC

**Isabelle Bedrosian, MD, FACS**  
The University of Texas MD Anderson  
Cancer Center  
Houston, TX

**Peter D. Beitsch, MD, FACS**  
Targeted Medical Education  
Dallas, TX  
@beitsch

**Danielle Bello, MD**  
Memorial Sloan Kettering Cancer Center  
New York, NY

**Michael P. Berry, MD, FACS**  
The Margaret West Comprehensive  
Breast Center  
Germantown, TN

**Sarah Blair, MD, FACS**  
University of California San Diego  
La Jolla, CA

**Richard J. Bleicher, MD, FACS**  
Fox Chase Cancer Center  
Philadelphia, PA  
@RichardBleicher

**Peter W. Blumencranz, MD, FACS**  
The Comprehensive Breast Cancer  
Center of Tampa Bay  
Clearwater, FL

**Susan K. Boolbol, MD, FACS**  
Mount Sinai Beth Israel  
New York, NY  
@sboolbol

**Judy C. Boughey, MD, FACS**  
Mayo Clinic  
Rochester, MN  
@DrJudyBoughey

**David R. Brenin, MD, FACS**  
University of Virginia Health Sciences  
Center  
Charlottesville, VA

**William E. Burak, MD, FACS**  
Memorial University Health System  
Savannah, GA

**M. Barbara Burke, MD, FACS**  
Overlake Medical Center  
Bellevue, WA

**Katherina Zabicki Calvillo, MD, FACS**  
Brigham and Women's Hospital  
Boston, MA

**Brittany Campbell, BS**  
Duke University Medical Center  
Durham, NC

**Michele M. Carpenter, MD, FACS**  
Orange County Breast Care Specialists  
Orange, CA  
@ladysurg

**Jodi M. Carter, MD, PhD**  
Mayo Clinic  
Rochester, MN

**Sarah P. Cate, MD**  
Icahn School of Medicine at Mount Sinai  
New York, NY

**Anees B. Chagpar, MD, MSc, MPH,  
MA, MBA, FRCS(C), FACS**  
Yale University School of Medicine  
New Haven, CT  
@aneeschagpar

**Abhishek Chatterjee, MD**  
Tufts Medical Center  
Boston, MA

**Steven L. Chen, MD, MBA, FACS**  
OasisMD  
San Diego, CA

**Rowan T. Chlebowski, MD, PhD**  
David Geffen School of Medicine  
Torrance, CA

**Saranya Chumsri, MD**  
Mayo Clinic Cancer Center  
Jacksonville, FL

**Patricia L. Clark, MD, FACS**  
Ironwood Cancer Center  
Scottsdale, AZ

**Costanza Cocilovo, MD, FACS**  
Inova Breast Care Institute  
Fairfax, VA

**Hiram (Chip) S. Cody, III, MD, FACS**  
Memorial Sloan-Kettering Cancer Center  
New York, NY

**Elizabeth Comen, MD**  
Memorial Sloan Kettering Cancer Center  
New York, NY

**Suzanne B. Coopey, MD, FACS**  
Massachusetts General Hospital  
Boston, MA

**Massimo Cristofanilli, MD, FACP**  
Robert H Lurie Comprehensive Cancer  
Center (RHLC), Fineberg School of  
Medicine  
Chicago, IL

**Lisa Curcio, MD, FACS**  
Breast Link – Laguna Hills  
Laguna Hills, CA

**Amy E. Cyr, MD, FACS**  
Washington University  
St. Louis, MO

**Brian J. Czerniecki, MD, PhD, FACS**  
Moffitt Cancer Center  
Tampa, FL

**Amy C. Degnim, MD, FACS**  
Mayo Clinic  
Rochester, MN

**Nancy DeMore, MD, FACS**  
Medical University of South Carolina  
Charleston, SC

**Neelima Denduluri, MD**  
Virginia Cancer Specialists, The US  
Oncology Network  
Arlington, VA  
@ndenduluri1

**Jill R. Dietz, MD, FACS**  
University Hospitals Case Medical Center  
Cleveland, OH

**Edward J. Donahue, MD, MS, FACS**  
St. Joseph's Hospital and Medical  
Center  
Phoenix, AZ  
@DonahueMD

**Stephen B. Edge, MD, FACS, FASCO**  
Roswell Park Cancer Institute  
Buffalo, NY

**Thomas L. Eisenhauer, MD, FACS**  
PARDEE – UNC Health Care  
Hendersonville, NC

**Souzan E. El-Eid, MD, FACS**  
US Oncology  
Las Vegas, NV

**Mahmoud El-Tamer, MD, FACS**  
Memorial-Sloan Kettering Cancer Center  
New York, NY

**David M. Euhus, MD, FACS**  
Johns Hopkins Hospital  
Baltimore, MD

**Marcio Fagundes, MD**  
Miami Cancer Institute  
Miami, FL

**Michael J. Farrell, MD, FACS**  
UHS Medical Group  
Vestal, NY

**Sheldon M. Feldman, MD, FACS**  
Montefiore Medical Center/Albert  
Einstein College of Medicine  
New York, NY

**Richard E. Fine, MD, FACS**  
The Margaret West Comprehensive  
Breast Center, West Cancer Center  
University of Tennessee Health Science  
Center  
Memphis, TN

**Gini Fleming, MD**  
University of Chicago Hospital  
Chicago, IL

**Sarah M. Friedewald, MD**  
Northwestern Medicine/Prentice  
Women's Hospital  
Chicago, IL

**Jennifer Gass, MD, FACS**  
Women and Infants' Hospital  
Providence, RI  
@jensgass

**Christopher C. Glaser, MD, FACS**  
Owensboro Health Regional Hospital  
Owensboro, KY

**Mehra Golshan, MD, FACS**  
Brigham and Women's Hospital  
Boston, MA  
@mgolshan1

**Stephen R. Grobmyer, MD, FACS**  
Cleveland Clinic  
Cleveland, OH

# 19<sup>TH</sup> ANNUAL MEETING

## faculty and presenters

**Janie G. Grumley, MD, FACS**  
Virginia Mason Medical Center  
Seattle, WA  
@janiedg

**Ryan A. Gruner, MD**  
BIDMC/Harvard  
Boston, MA

**Jay K. Harness, MD, FACS**  
St. Joseph Hospital  
Orange, CA

**Ronda Henry-Tillman, MD, FACS**  
University of Arkansas for Medical  
Sciences  
Little Rock, AR

**Tina J. Hieken, MD, FACS**  
Mayo Clinic  
Rochester, MN

**Dennis R. Holmes, MD, FACS**  
John Wayne Cancer Institute  
Santa Monica, CA  
@DoctorHolmesLA

**Marissa M. Howard-McNatt, MD,  
FACS**  
Wake Forest Baptist Health  
Winston-Salem, NC

**Kevin S. Hughes, MD, FACS**  
Massachusetts General Hospital  
Boston, MA

**Kelly Hunt, MD, FACS**  
The University of Texas at MD  
Anderson Cancer Center  
Houston, TX

**E. Shelley Hwang, MD, MPH, FACS**  
Duke University Medical Center  
Durham, NC

**David M. Hyams, MD, FACS**  
Desert Surgical Oncology  
Rancho Mirage, CA

**Hiroji Iwata, MD, PhD**  
Aichi Cancer Center Hospital, Breast  
Oncology  
Nagoya, Japan

**Ted A. James, MD, MHCM, FACS**  
Beth Israel Deaconess Medical Center  
Boston, MA  
@tedjamesmd

**Nora Jaskowiak, MD, FACS**  
University of Chicago  
Chicago, IL

**Jacqueline S. Jeruss, MD, PhD, FACS**  
University of Michigan Comprehensive  
Cancer Center  
Ann Arbor, MI

**Scott R. Karlan, MD, FACS**  
Cedars-Sinai Medical Center  
Los Angeles, CA

**Cary S. Kaufman, MD, FACS**  
University of Washington/Bellingham  
Regional Breast Center  
Bellingham, WA

**David I. Kaufman, MD, FACS**  
Breast Care Specialists  
Hofstra Northwell School of Medicine  
Bethpage, NY

**John Kennedy, MD, FACS**  
DeKalb Surgical Associates  
Decatur, GA  
@jskennedymd

**Sadia Khan, DO, FACS, FACOS**  
Hoag Memorial Hospital Presbyterian  
Keck School of Medicine  
The University of Southern California  
Newport Beach, CA

**Brigid K. Killelea, MD, MPH, FACS**  
The Breast Center - Smilow Cancer  
Hospital at Yale—  
New Haven  
New Haven, CT

**V. Suzanne Klimberg, MD, PhD, FACS**  
The University of Texas Medical Branch  
Galveston, TX

**Anne M. Kobbermann, MD, FACS**  
Midwest Breast Care  
Overland Park, KS

**Katherine A. Kopkash, MD, FACS**  
NorthShore University HealthSystem  
Evanston, IL

**Henry M. Kuerer, MD, PhD, FACS**  
The University of Texas MD Anderson  
Cancer Center  
Houston, TX  
@HenryKuerer

**Swati Kulkarni, MD, FACS**  
Northwestern University  
Chicago, IL

**Scott H. Kurtzman, MD**  
Waterbury Hospital  
Waterbury, CT

**Raluca N. Kurz, MS, LCGC**  
UCLA School of Public Health  
Los Angeles, CA

**M. Catherine Lee, MD, FACS**  
Moffitt Cancer Center at McKinley Drive  
Tampa, FL

**Anthony Lucci, MD, FACS**  
The University of Texas MD Anderson  
Cancer Center  
Houston, TX

**Terry P. Mamounas, MD, MPH, FACS**  
Orlando Health  
Orlando, FL

**Eric R. Manahan, MD, MBA, FACS**  
Southeastern Breast Care Specialists  
Dalton, GA  
@ermanmd

**Julie A. Margenthaler, MD, FACS**  
Washington University School of  
Medicine  
St. Louis, MO  
@margenthalerj

**Sarah A. McLaughlin, MD, FACS**  
Mayo Clinic  
Jacksonville, FL

**Jane E. Méndez, MD, FACS**  
Miami Cancer Institute  
Miami, FL

**Funda Meric-Bernstam, MD, FACS**  
UT-MD Anderson Cancer Center  
Houston, TX

**James Merlino, MD, FACS**  
Press Ganey  
Richfield, OH

**Elizabeth A. Mittendorf, MD, PhD,  
FACS**  
Dana-Farber/Brigham and Women's  
Cancer Center  
Boston, MA

**Leslie L. Montgomery, MD, FACS**  
Hackensack University Medical Center  
Hackensack, NJ

**Cindy H. Moon, MPP, MPH**  
Hart Health Strategies  
Washington, DC

**Meena S. Moran, MD**  
Yale University School of Medicine  
New Haven, CT

**Monica Morrow, MD, FACS**  
Memorial Sloan Kettering Cancer Center  
New York, NY

**Brittany Murphy, MD**  
Mayo Clinic  
Rochester, MN

**Faina Nakhlis, MD, FACS**  
Brigham and Women's Hospital/Dana  
Farber Cancer Institute  
Boston, MA

**Heather B. Neuman, MD, FACS**  
University of Wisconsin School of  
Medicine and Public Health  
Madison, WI

**Lisa A. Newman, MD, MPH, FACS,  
FASCO**  
Henry Ford Health System  
Detroit, MI

**Gillian M. Newstead, MD, FACR**  
University of Chicago  
Burr Ridge, IL

**David W. Ollila, MD, FACS**  
University of North Carolina at  
Chapel Hill  
Chapel Hill, NC  
@surginsydney

**Olufunmilayo I. Olopade, MD, FACP**  
The University of Chicago Medicine  
Chicago, IL

**Ruth O'Regan, MD**  
University of Wisconsin  
Madison, WI

**Helen A. Pass, MD, FACS**  
Stamford Hospital  
Stamford, CT

**Sharla Gayle Patterson, MD, MBA,  
FACS**  
Naples Community Hospital  
Naples, FL

**Lashan Peiris, MBBS, BSc,  
FRCS(Lon)**  
Meadowlark Health Center  
Edmonton, AB  
Canada

**Anne Peled, MD**  
Private Practice  
University of California, San Francisco  
School of Medicine  
San Francisco, CA

# 19<sup>TH</sup> ANNUAL MEETING

## faculty and presenters

**James V. Pellicane, MD, FACS**  
Bon Secour/Virginia Breast Center, Inc.  
Midlothian, VA  
@jpellicane

**Catherine Pesce, MD, FACS**  
NorthShore University Health System  
Evanston, IL

**Andrea Pusic, MD, FACS**  
Memorial-Sloan Kettering Cancer Center  
New York, NY

**Roshni Rao, MD, FACS**  
New York Presbyterian Hospital/  
Columbia University Medical Center  
New York, NY

**Jocelyn Rapelyea, MD**  
George Washington University Medical  
Faculty Associates  
Washington, DC

**Juliann M. Reiland, MD, FACS**  
Avera Medical Group  
Sioux Falls, SD  
@DrJulieReiland

**Helene Retrouvey, MDCM**  
University of Toronto  
Toronto, ON  
@HeleneRetrouvey

**Mark E. Robson, MD**  
Memorial-Sloan Kettering Cancer Center  
New York, NY  
@MarkRobsonMD

**Becky Rodrian, BSN, CCS-P, CPC,  
CBCS, MBS, CEMC, CPEDC**  
Panacea Healthcare Solutions, A Career  
Step Company  
St. Paul, MN

**Bruce Rose, MD, PhD**  
Brown Fertility  
Jacksonville, FL

**Barry S. Rosen, MD, FACS**  
Advocate IL Masonic Medical Center  
Chicago, IL

**Terry Sarantou, MD, FACS**  
Levine Cancer Institute, Carolinas  
Medical Center  
Charlotte, NC

**Molly L. Sebastian, MD, FACS**  
Virginia Hospital Center  
Arlington, VA

**Stephen F. Sener, MD, FACS**  
University of Southern California  
Los Angeles, CA

**Elizabeth A. Shaughnessy, MD,  
PhD, FACS**  
University of Cincinnati  
Cincinnati, OH

**Sabrina Shilad, MD, FACS**  
Cleveland Clinic Foundation  
Cleveland, OH  
@DrSabrinaShilad

**Mark Sisco, MD, FACS**  
NorthShore University HealthSystem  
Northbrook, IL

**Barbara L. Smith, MD, PhD, FACS**  
Harvard Medical School  
Boston, MA

**Linda A. Smith, MD, FACS**  
Breast Surgeon  
Albuquerque, NM

**Howard C. Snider, Jr., MD, FACS**  
Breast Surgeon  
Pike Road, AL

**Georgia G. Spear, MD**  
NorthShore Medical Group  
Evanston, IL

**Darrow Speyer, MGC, CGC**  
GeneDX  
Gaithersburg, MD

**Edgar D. Staren, MD, PhD, MBA,  
FACS**  
TransMed7, LLC  
Paradise Valley, CA

**Lacey Stelle, MD**  
Anne Arundel Medical Center  
Annapolis, MD

**Nina Tamirisa, MD**  
Duke University Medical Center  
Durham, NC

**Lorraine Tafra, MD, FACS**  
Anne Arundel Medical Center  
Annapolis, MD

**Walton A. Taylor, MD, FACS**  
True Surgical Partners  
Dallas, TX

**Sarah Tevis, MD**  
University of Texas MD Anderson  
Cancer Center  
Houston, TX

**Paul Thiruchelvam, BSc, MD, FRCS,  
PhD**  
Imperial College Healthcare, London  
London, England  
@ptrthiru

**Carrie A. Thoms, MD, FACS**  
Fox Valley Surgical Associates  
Appleton, WI

**Alyssa D. Throckmorton, MD, FACS**  
Baptist Medical Group – Memphis  
Breast Care  
Memphis, TN  
@throckad

**Stacey Tinianov**  
Patient Advocate  
Santa Clara, CA  
@coffeemommy

**Amy Trentham-Dietz, PhD**  
University of Wisconsin School of  
Medicine and Public Health  
Madison, WI

**John F. Turner, III, MD, FACS**  
Thyra M. Humphreys Center for  
Breast Health  
Lewisburg, PA

**Todd M. Tuttle, MD, FACS**  
University of Minnesota  
Minneapolis, MN

**Gary W. Unzeitig, MD, FACS**  
Doctors Hospital of Laredo  
Laredo, TX

**Rashmi P. Vaidya, MD, FACS**  
Ironwood Cancer and Research Centers  
Glendale, AZ

**Dariusz Vaziri, MD, FACS**  
Breast Surgeon  
Vero Beach, FL

**Kathryn A. Wagner, MD, FACS**  
Texas Oncology PA  
San Antonio, TX

**Irene L. Wapnir, MD, FACS**  
Stanford University Medical Center  
Stanford, CA

**Amanda J. Wheeler, MD, FACS**  
Stanford University School of Medicine  
Stanford, CA

**Richard L. White, Jr., MD, FACS**  
Carolinas Medical Center  
Charlotte, NC

**Pat W. Whitworth, MD, FACS, FSSO**  
Nashville Breast Center  
Nashville, TN  
@WhitworthMD

**Lee G. Wilke, MD, FACS**  
University of Wisconsin Health/School  
of Medicine and Public Health  
Madison, WI

**Shawna C. Willey, MD, FACS**  
MedStar Georgetown University  
Hospital  
Washington, DC  
@SCWilley

**Austin D. Williams, MD, MSED**  
University of Pennsylvania  
Philadelphia, PA  
@adwilliams5

**David J. Winchester, MD, FACS**  
NorthShore University HealthCare  
Evanston, IL

**Jan A. Wong, MD**  
East Carolina University  
Greenville, NC

**Marie E. Wood, MD**  
University of Vermont Medical Center  
Burlington, VT

**Katharine A. Yao, MD, FACS**  
NorthShore University HealthSystem,  
Evanston Hospital  
Evanston, IL

**Victor J. Zannis, MD, FACS**  
Comprehensive Breast Center of  
Arizona – Greenway  
Phoenix, AZ

# 19<sup>TH</sup> ANNUAL MEETING

## commercial exhibits and supporters

Visit the industry's top vendors in the Exhibit Hall located in the Coquina Ballroom. Exhibitors will showcase the latest technology and the newest procedures. You will be able to meet with company representatives and see this technology first-hand.

The American Society of Breast Surgeons gratefully acknowledges the unrestricted educational grants, marketing support, and gifts in kind received from the following companies and thanks them for helping the Society continue its mission of encouraging the study of breast surgery, promoting research and development of advanced surgical techniques, improving the standards of practice for breast surgery in the United States, and serving as a forum for the exchange of ideas.

### Educational Grants/Gifts in Kind\*

BD/Bard Biopsy Systems	Kubtec Medical Imaging
Carl Zeiss Meditec, Inc.	Mammotome
Cianna Medical, Inc.	Medtronic Advanced Energy, LLC
Dune Medical Devices, Inc.	Merck, Inc.
Faxitron	OBP Medical
Focal Therapeutics, Inc.	Pacira Pharmaceuticals
Fujifilm SonoSite, Inc.	RGS Healthcare
Genentech, Inc.	Siemens Healthineers
Hitachi Healthcare	Terason Corporation
Hologic, Inc.	TransMed7, LLC
IntraOp Medical, Inc.	United Medical Systems, Inc.
Invuity, Inc.	Vector Surgical
John Wayne Cancer Foundation	W.L. Gore & Associates, Inc.
Johnson & Johnson Medical Devices	

### Marketing Support\*

23andMe, Inc.	Genomic Health, Inc.
Albert Einstein College of Medicine	Hologic, Inc.
Allergan	ImpediMed, Inc.
Ambry Genetics	Invuity, Inc.
BD/Bard Biopsy Systems	Merck, Inc.
Cianna Medical, Inc.	Myriad Genetic Laboratories, Inc.
Focal Therapeutics, Inc.	Pacira Pharmaceuticals
Genentech, Inc.	

*\*as of 4/9/18*

### Industry Relations Council Members

AirXpanders  
Dune Medical Devices, Inc.  
Genentech, Inc.  
Genomic Health, Inc.  
Invuity, Inc.

### Exhibitor Registration and Housing Hours

*Mediterranean Registration Desk  
JW Marriott, Lobby Level*

Tuesday .....	5:00 pm–7:30 pm
Wednesday .....	6:00 am–6:00 pm
Thursday .....	6:00 am–7:30 pm
Friday .....	6:00 am–4:30 pm
Saturday .....	6:00 am–Noon

### Exhibit Hall Hours, General Session Breaks and Lunch Schedule for the Exhibit Hall

*Coquina Ballroom  
JW Marriott, Lobby Level*

#### Thursday, May 3

Opening Reception 7:30 pm–9:00 pm

#### Friday, May 4

Exhibit Hall Hours.....9:00 am–4:00 pm  
AM Break .....9:30 am–10:00 am  
Lunch .....Noon–1:15 pm  
PM Break .....3:30 pm–4:00 pm

#### Saturday, May 5

Exhibit Hall Hours.....9:00 am–4:00 pm  
AM Break .....9:15 am–9:45 am  
Lunch .....Noon–1:30 pm  
PM Break .....3:15 pm–3:45 pm



# 19<sup>TH</sup> ANNUAL MEETING

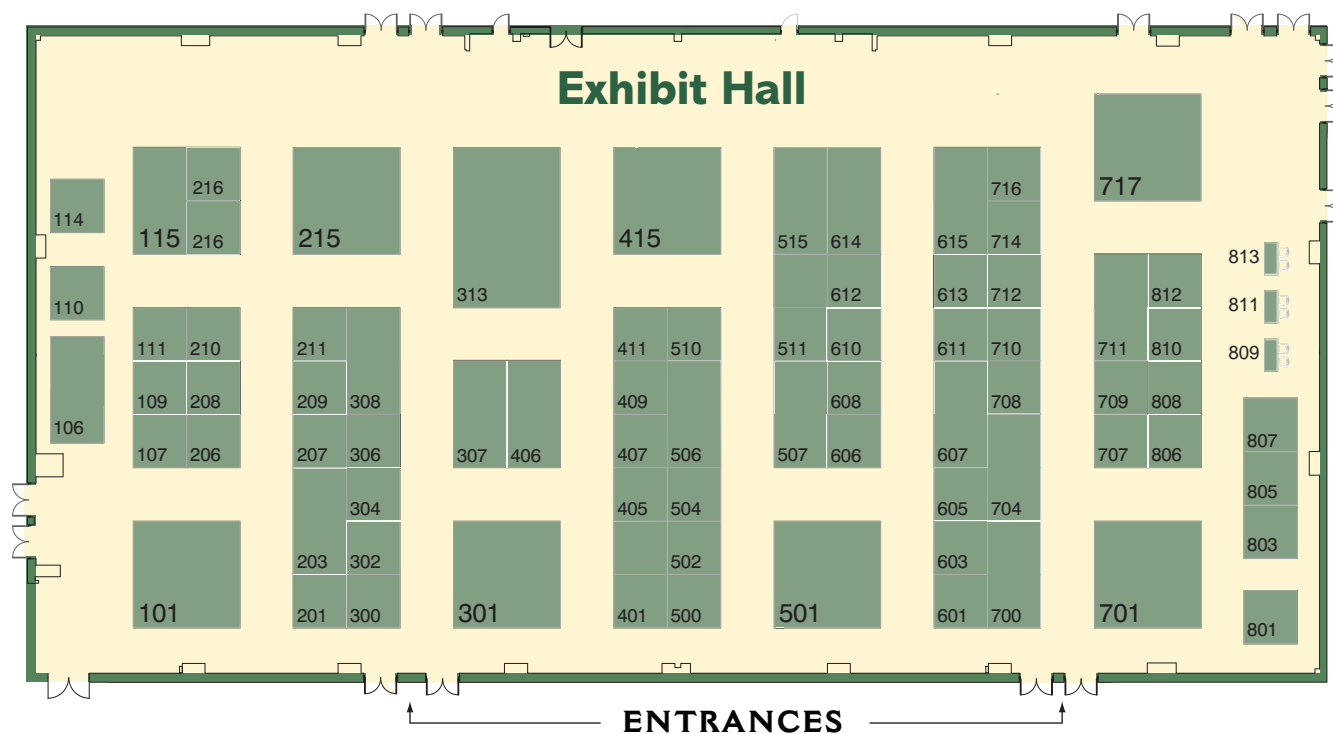

## List of Exhibitors

Company Name	Booth No.	Company Name	Booth No.	Company Name	Booth No.
2View, LLC	409	Faxitron	203	Merck	115
AcuLux, Inc.	812	Focal Therapeutics, Inc.	711	Mitaka USA	806
AirXpanders, Inc.	603	Fujifilm SonoSite	707	Myriad Genetic Laboratories Inc	701
Allergan	406	GE Healthcare	216	National Accreditation Program for Breast Centers (NAPBC)	809
Ambry Genetics	210	Genentech	601	OBP Medical	511
Applied Medical	610	Genomic Health	300	Olympus America, Inc.	209
Bard Biopsy	501	Halyard	613	Pacira Pharmaceuticals	106
Best Medical International	313	Hitachi Healthcare	606	Perimeter Medical Imaging Inc	504
Boiron	407	Hologic, Inc.	301	PreludeDx	607
Boss Instruments	612	IceCure Medical, Inc.	708	Progeny Genetics	208
Buffalo Filter	211	ImpediMed	700	Quest Diagnostics	502
Cardinal Health	304	Infinity Massage Chairs	805	RGS Healthcare	801
Care Wise c/o Southern Scientific Ltd	709	Intramedical Imaging	207	Ronin Surgical Corp	214
Carl Zeiss Meditec, Inc.	704	IntraOp Medical Corporation	308	School of Oncoplastic Surgery	712
CBLPath	714	Invitae	306	Siemens Healthineers	807
Cianna Medical, Inc.	307	Invuity	215	Stryker	614
ClearCut Medical	605	IsoAid	110	Terason	401
CMR Naviscan Corporation	411	Jeunesse Innovations	109	The Permanente Medical Group, Inc.	808
Cohera Medical, Inc.	710	Knitted Knockers Support Foundation	813	The US Oncology Network	608
Concure Oncology – Breast Microseed Treatment	615	Kubtec Medical Imaging	507	TransMed7, LLC	506
Dilon Technologies Inc	500	LeBeau Medical	111	TS Medical USA	803
Dune Medical Devices, Inc.	101	Living Beyond Breast Cancer	811	United Medical Systems	510
EduCare	206	Lumicell	114	Vector Surgical	515
Edward-Elmhurst Healthcare	810	Mammotome	415	Wolters Kluwer	716
Elucent Medical	107	Masthead	405	Xoft, a subsidiary of iCAD Inc.	201
Enova Illumination	611	Medtronic	717		

# SET THE PACE

in Core Needle Biopsy

## BARD® MARQUEE®

Disposable Core Biopsy Instrument

### Powerful. Precise.

Unparalleled procedural versatility from a comprehensive core needle offering two firing modes and two penetration depths.



**POWERFUL**  
Automatic fire mode gives you the power you've come to expect from Bard core needles.

**ADJUSTABLE**  
Dual mode disposable core biopsy device with an adjustable penetration depth that offers you a choice between 18 mm and 25 mm for additional control.

**PRECISE**  
Semi-automatic mode enables you to fire the stylet only, providing you with visual confirmation of the sample notch placement.

**SET THE PACE in Biopsy—**  
**Visit us at ASBrS Booth 501**

Please consult product labels and inserts for any indications, contraindications, hazards, warnings, precautions and directions for use.

1.800.321.4254 [bardbiopsy.com](http://bardbiopsy.com)

© 2018 BD. BD, the BD Logo and all other trademarks are property of Becton, Dickinson and Company. BPV/BBFA/0716/0023(1)



**BARD**

has joined BD

 YES NO ~~MAYBE~~

## Don't deal with MAYBES.

When it comes to node-positive disease, a low-risk group with a 19.4% rate of recurrence is unacceptable. My team needs accurate results--not maybes. The EndoPredict breast cancer recurrence test combines a 12-gene molecular score with clinical features to identify patients with a true low risk of recurrence, regardless of nodal status--so we can guide our patients with confidence.<sup>1,2</sup>

**Go forward with conviction.**

Learn more at [www.endopredict.com](http://www.endopredict.com)

**References:** 1. Buss R, Sestak I, Kronenwett R, et al. Comparison of EndoPredict and EPclin with Oncotype DX recurrence score for prediction of risk of distant recurrence after endocrine therapy (supplementary materials). *J Natl Cancer Inst.* 2016;108(11). 2. Sestak I, Buss R, Cuzick J, et al. Comparison of the performance of 6 prognostic signatures for Estrogen Receptor-Positive breast cancer: A secondary analysis of a randomized clinical trial. *JAMA Oncol.* 2018 Feb 15. doi:10.1001/jamaoncol.2017.5524 [Epub ahead of print]

Myriad, the Myriad logo, EndoPredict, and the EndoPredict logo, are either trademarks or registered trademarks of Myriad Genetics, Inc., and its subsidiaries, in the United States and other jurisdictions. Copyright © 2018 Myriad Genetics, Inc. All rights reserved. EPMCTY/3-1